

37" Gard-N-Post™ Support for Outdoor Light Fixtures

Two-piece, super tall Gard-N-Post™. Supports most light fixtures and/or GFCI wiring devices. UV rated plastic for long outdoor life. Four non-chipping colors.

FEATURES AND BENEFITS

- Molded-in color is permanent—unlike painted posts where lawn equipment chips the color off
- Openings on both sides of the post for back-to-back power
- Low voltage separator provided for Power use on one side and Low Voltage on the other (phone, security, & cable TV)
- Built-in stabilizers need no assembly and provide rigid support
- Angle cut post for easy access to underground wiring
- (2) combination KOs for a UL Listed enclosure
- May be field modified for time clocks and disconnects

CATALOG NUMBER	UPC/DCI/NAED MFG #018997	DESCRIPTION	UNIT PKG	STD PKG	DIM A	DIM B	DIM C	DIM D
GP37B	76153	Black	1	4	9.000	4.000	25.000	12.000
GP37BR	76154	Bronze	1	4	9.000	4.000	25.000	12.000
GP37G	76156	Green	1	4	9.000	4.000	25.000	12.000
GP37W	76155	White	1	4	9.000	4.000	25.000	12.000

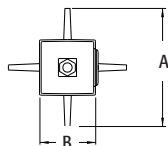
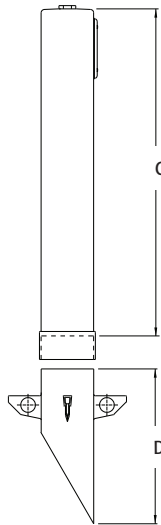

2-Piece SUPER TALL GARD-N-POST

Add suffix "GC" to Catalog # when ordering in Canada, for example GP37BGC. See GPX18 Extender (optional) on page J-6. CSA listed with grounding lug. **PATENTED.**

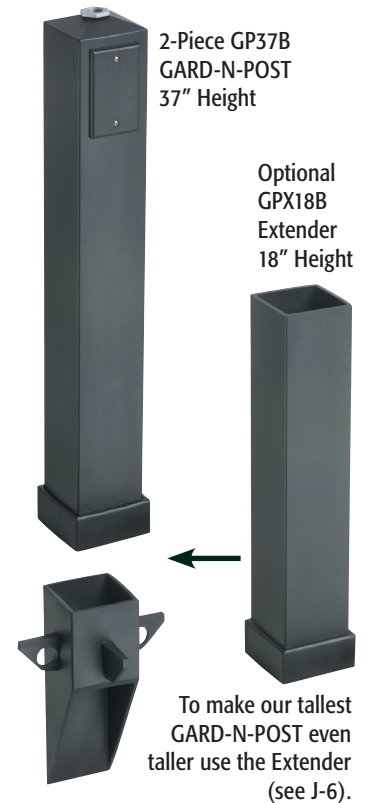

To make our tallest GARD-N-POST even taller use the Extender (see J-6).

COMES COMPLETE WITH...

Installed 3/4" x 1/2" NPT metal reducing bushing, locknut with copper ground wire for fixture installation, (2) blank device plates, gaskets & screws, plug for top hole (when fixture is not installed), low voltage separator, and removable KO plate.

COMPARE



To assemble (with or without the Extender) use standard PVC cement.

Add the Low Voltage Separator to run Low Voltage on one side and Power on the other!